



CONTRACTOR'S GUIDE

OVERVIEW

Introduction	04
Installation workflow	06
Index of parts	07

1

WALL CONSTRUCTION

1.1 Preferred wall type	09
1.2 Other wall types	10
1.3 Pre-existing conditions	11

2

ROUGH-INS

2.1 Reading a drawing	12
2.2 Dos and don'ts	13
2.3 Pre-existing conditions	14

3

SITE PREPARATION

3.1 Checklist	15
3.2 Rough-in locations	16

4

BENTOBUILD INSTALLATION

4.1 Lattice installation	17
4.2 Module installation	18

5

FINAL HOOKUP

5.1 Plumbing	19
5.2 Electrical	23
5.3 Appliances	25



OVERVIEW

Introducing the BentoBuild Lattice System

The **BentoBuild Lattice System** is a modular wall mounting system.

Our grid-based system allows for the quick and easy mounting of modules to virtually any wall type. The system combines horizontal ledgers with vertical struts to maximize strength and flexibility.

The purpose of this guide is to instruct contractors or other qualified individuals on the preparation of walls to accept the BentoBuild Lattice System.

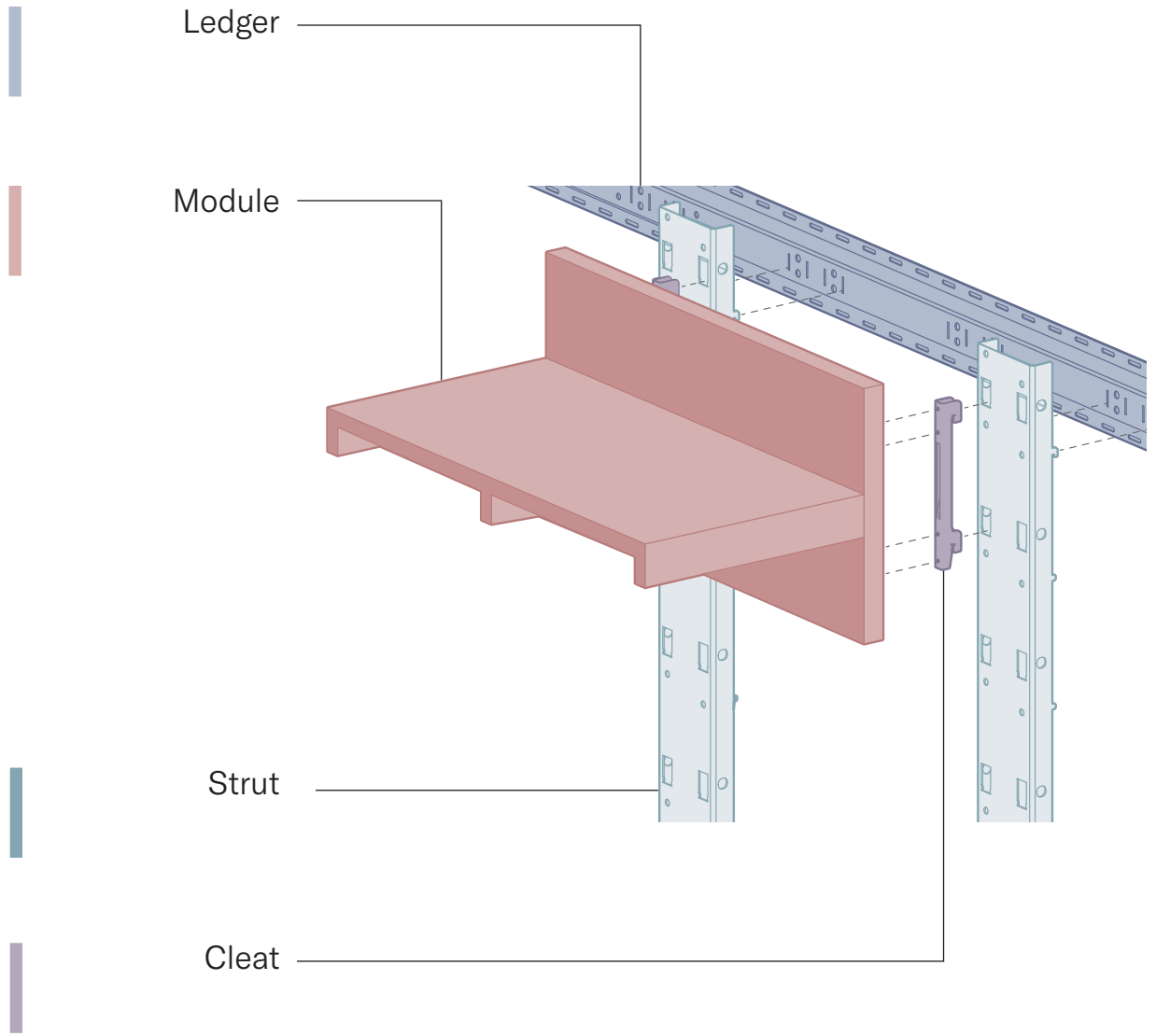

Installation workflow

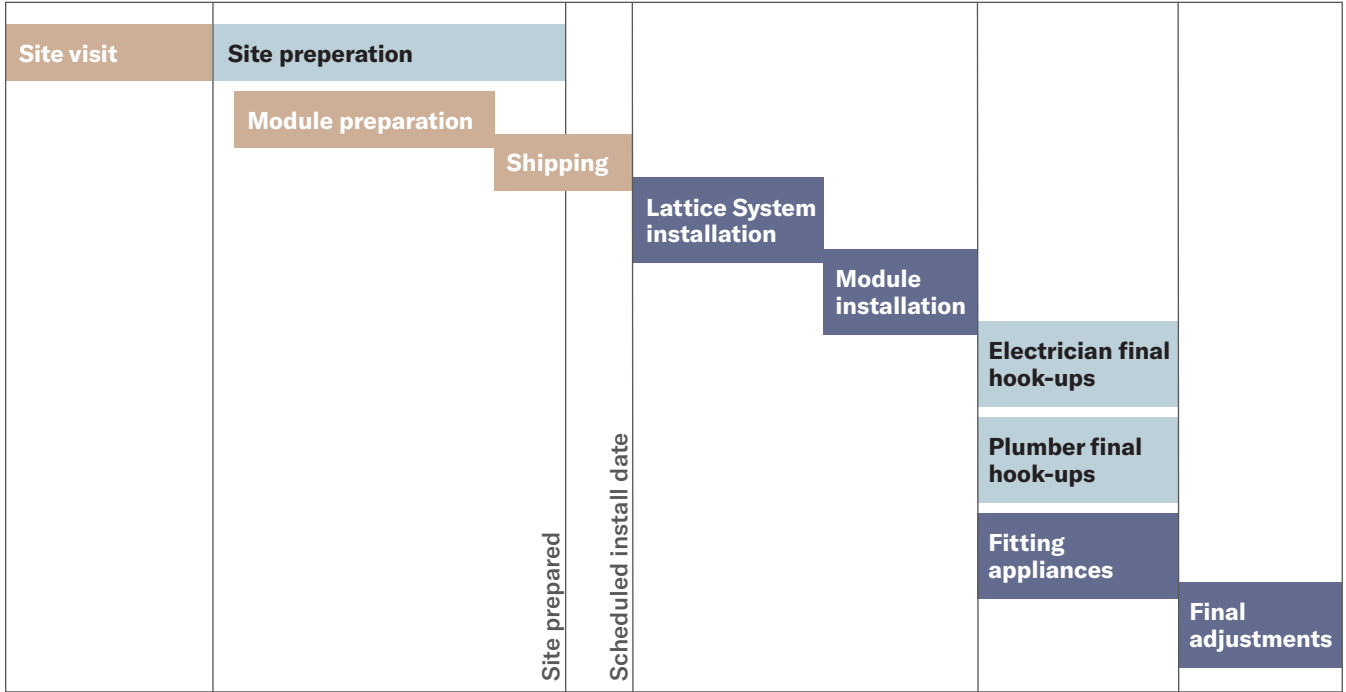

Timeline based off installation of 1 x 12ft kitchen. Timeline subject to change based on quantity and size.

Note: Before fitting the BentoBuild Lattice System, ensure standard professional building practices have been used for the wall construction.

BentoBuild's responsibility	Providing the Lattice System and Series 001 modules
Contractor's responsibility	Making sure that the wall matches BentoBuild specifications
	Making all plumbing and electrical connections (hook-ups)
Furniture installer's responsibility	Lattice System installation
	Modules installation
	Fitting appliances (no hook-ups)
	Final adjustments

Index of parts

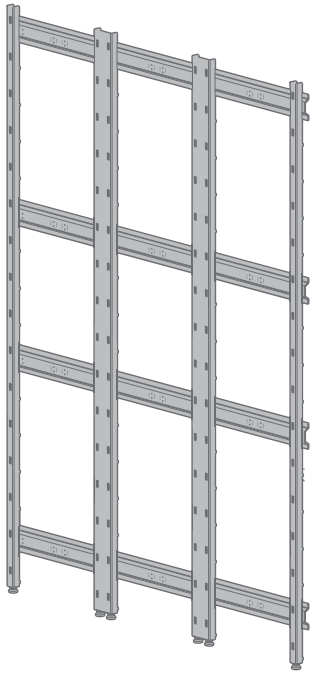

Our **Lattice System** is a system of struts, ledgers, and other components that create a modular mounting grid on a wall.

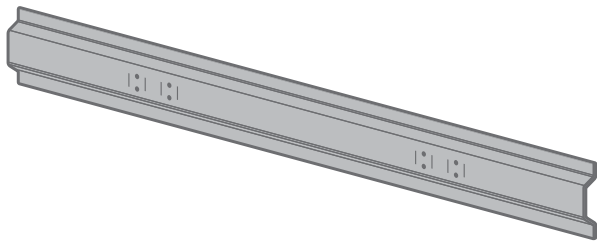

Ledgers are horizontal pieces that are attached directly to a wall.

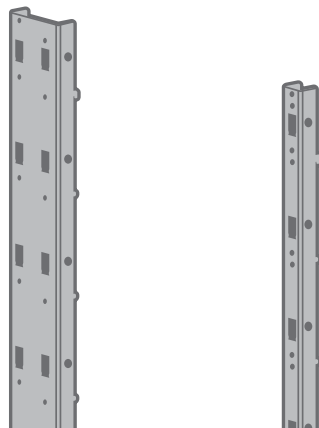

Struts are vertical pieces that hang off a ledger, which connect to cleats.

Half struts are useful where the Lattice System ends. Wider, full struts are used where modules meet in the middle of the Lattice System assembly.



Cleats attach modules to the Lattice System.

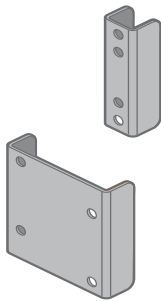

Strut connectors join struts together.

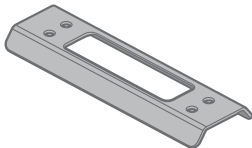

Ledger connectors join ledgers together.

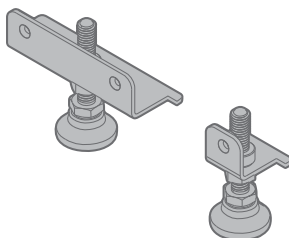

Leveling feet attach to the bases of struts, which enable them to stand on a floor surface and support heavy loads.

1 WALL CONSTRUCTION

1.1 Preferred wall type

The BentoBuild Lattice System can be attached to many different types of wall surfaces but, for ease of installation, we recommend $\frac{5}{8}$ " gypsum wall board over $\frac{1}{2}$ " OSB or plywood on wood or metal studs with a minimum of a level 2 finish wherever the BentoBuild Lattice System will be used.

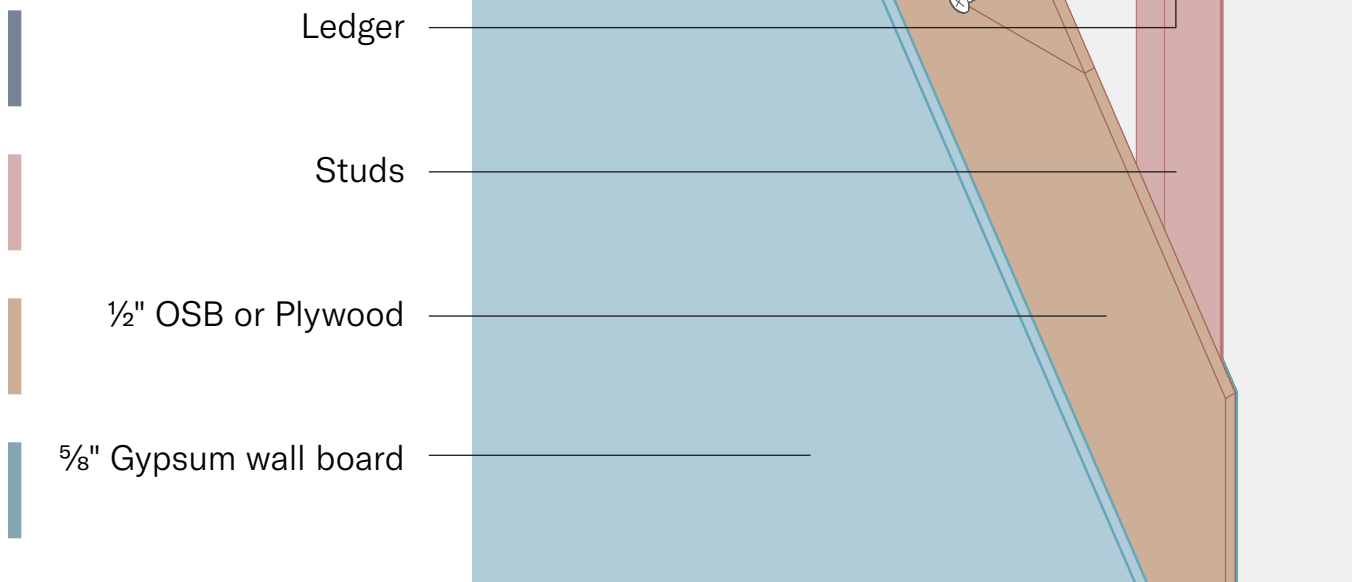

1.2 Other wall types

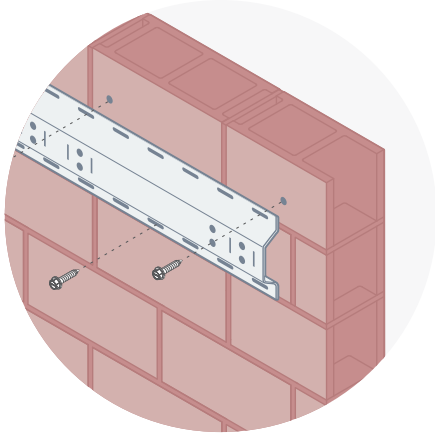

Solid wall

For masonry walls use $\frac{3}{16}$ " x 1- $\frac{1}{4}$ " Hex Tapcon concrete screws. These should be placed in a zig zag pattern top to bottom with roughly 12" spacing. Pre-drill pilot holes with $\frac{5}{16}$ " masonry bit using hammer drill. Screw concrete screws through the ledger into pilot holes.

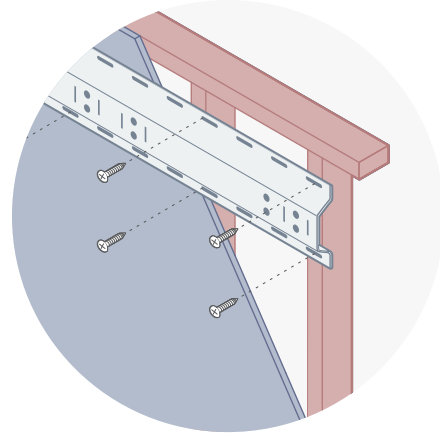

Wood or metal stud wall

Locate wall studs using a stud finder. Studs are typically 16" on center. Fasten the ledgers to every available stud using 8 1- $\frac{1}{2}$ " drywall screws and a drill.

1.3 Working with pre-existing conditions

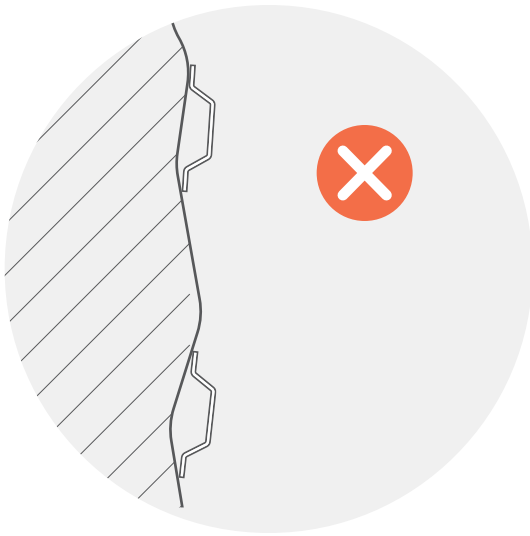

Bad wall

Requires shims to true up.

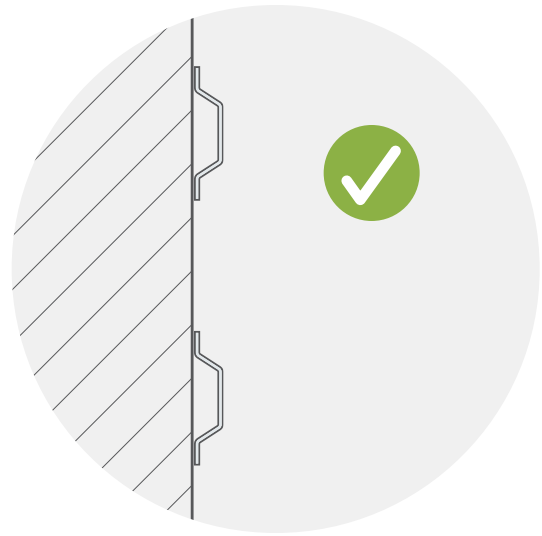

Good wall

2 ROUGH-INS

2.1 Reading a drawing

We will provide a drawing set depicting our Lattice System layout and the final configuration layout.

Rough-in locations are recommendations only. Refer to plans by your project architect for final rough-in locations. BentoBuild is not responsible for specifying rough-in locations. Please note any discrepancies between BentoBuild recommended rough-in locations and plans provided by others as this may cause difficulty in final electrical and plumbing installation.

LEGEND

1	Trimmed-out, dedicated outlet for appliances, typical.
2	Leave 3ft of armored cable hanging to connect to outlet mounted in backsplash
3	Drain and water supply

Before module installation

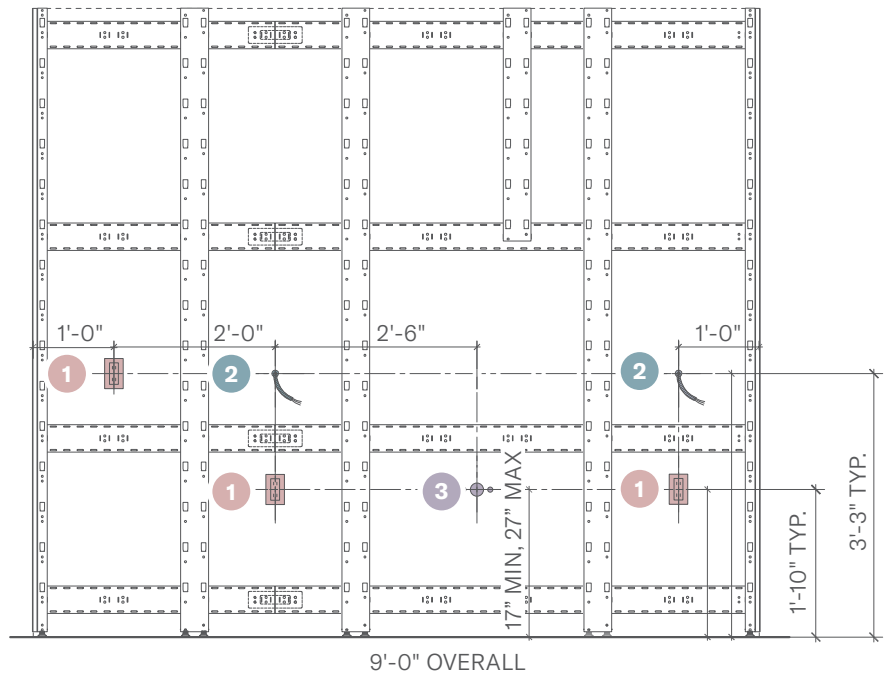

After module installation

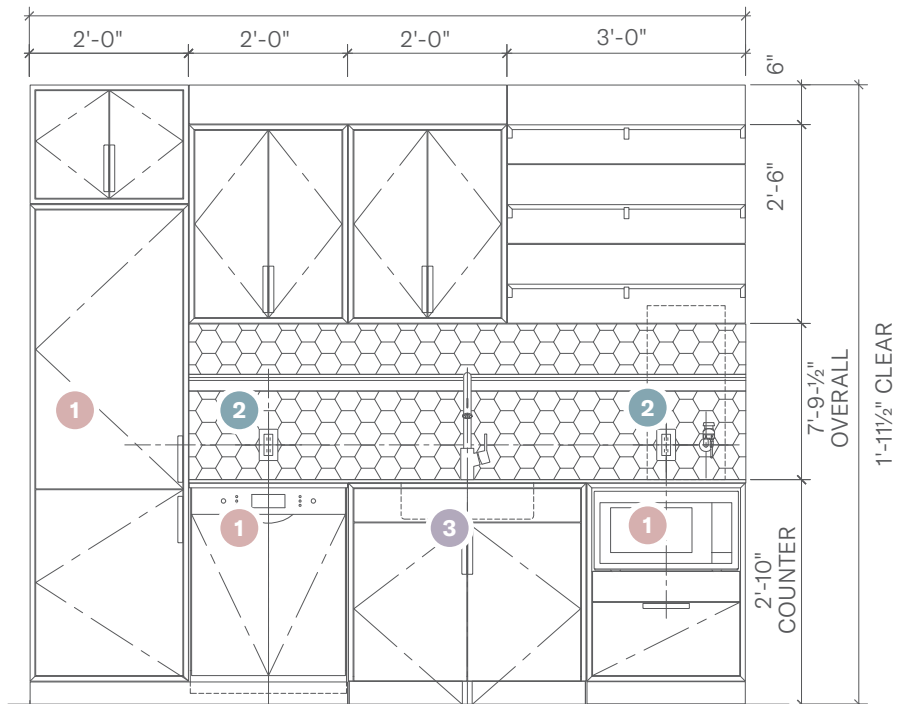

2.2 Dos and don'ts

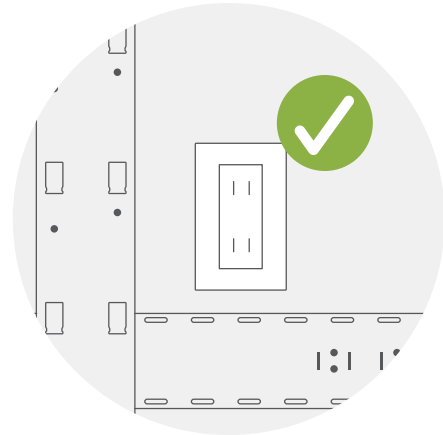
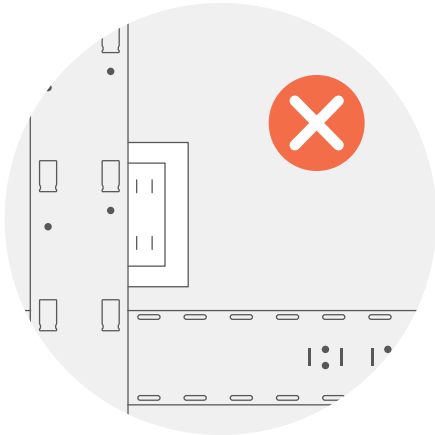

Electrical outlets

should always be accessible, never blocked.

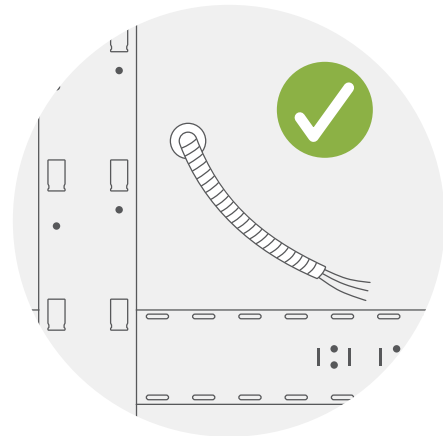
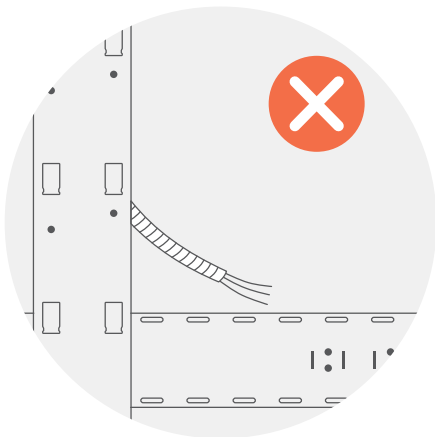

Armored cables

should always be accessible, never blocked.

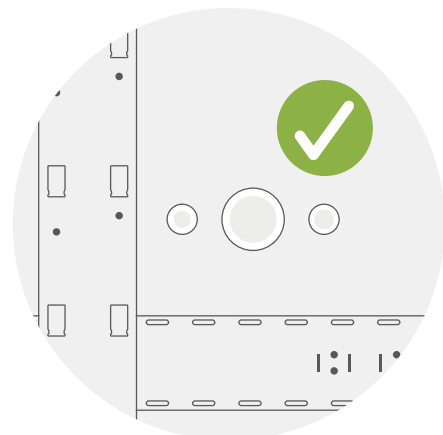
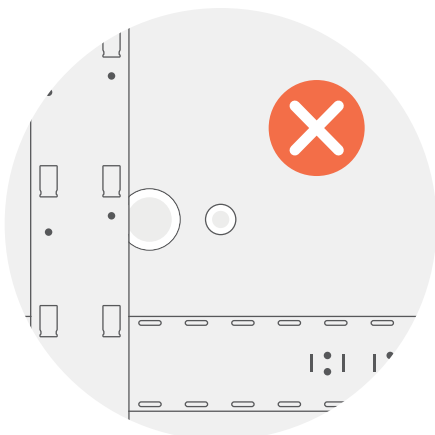

Water supply and drain

should always be accessible, never blocked.

2.3 Working with pre-existing conditions



Working with pre-existing conditions

If you need to remove an outlet, cut it out completely and patch the area.

3 SITE PREPARATION



Note: Furniture installers will not be able to perform work unless the following steps are completed.

3.1 CHECKLIST

- Make sure that standard professional building practices have been used for the wall construction.
- Make sure the wall is plumb and true.
- Mark out where the electrical and plumbing lines run in the wall to avoid drilling into them.
- Check if the rough-in locations match the locations specified in provided drawing set.
- Fully trim out electrical devices (note: Whips can be left where outlets are mounted on BentoBuild Lattice System).
- In the event of any differences between the architectural plans and BentoBuild drawing sets, please refer to the plans provided by the team managing the installation and design. BentoBuild is not responsible for discrepancies between our instructions and any other plans provided.
- We recommend a level 2 paint finish for walls.
- Leave 3 feet of extra armored cable at specified locations.
- Make sure to keep all areas clear and free of obstacles before installing the Lattice System.

3.2 Rough-in locations

Make sure the plumbing and electrical rough-ins match the information provided by the project designer.

Ensure the wall, rough-ins and site have been prepared according to this guide prior to BentoBuild Lattice System Installation.

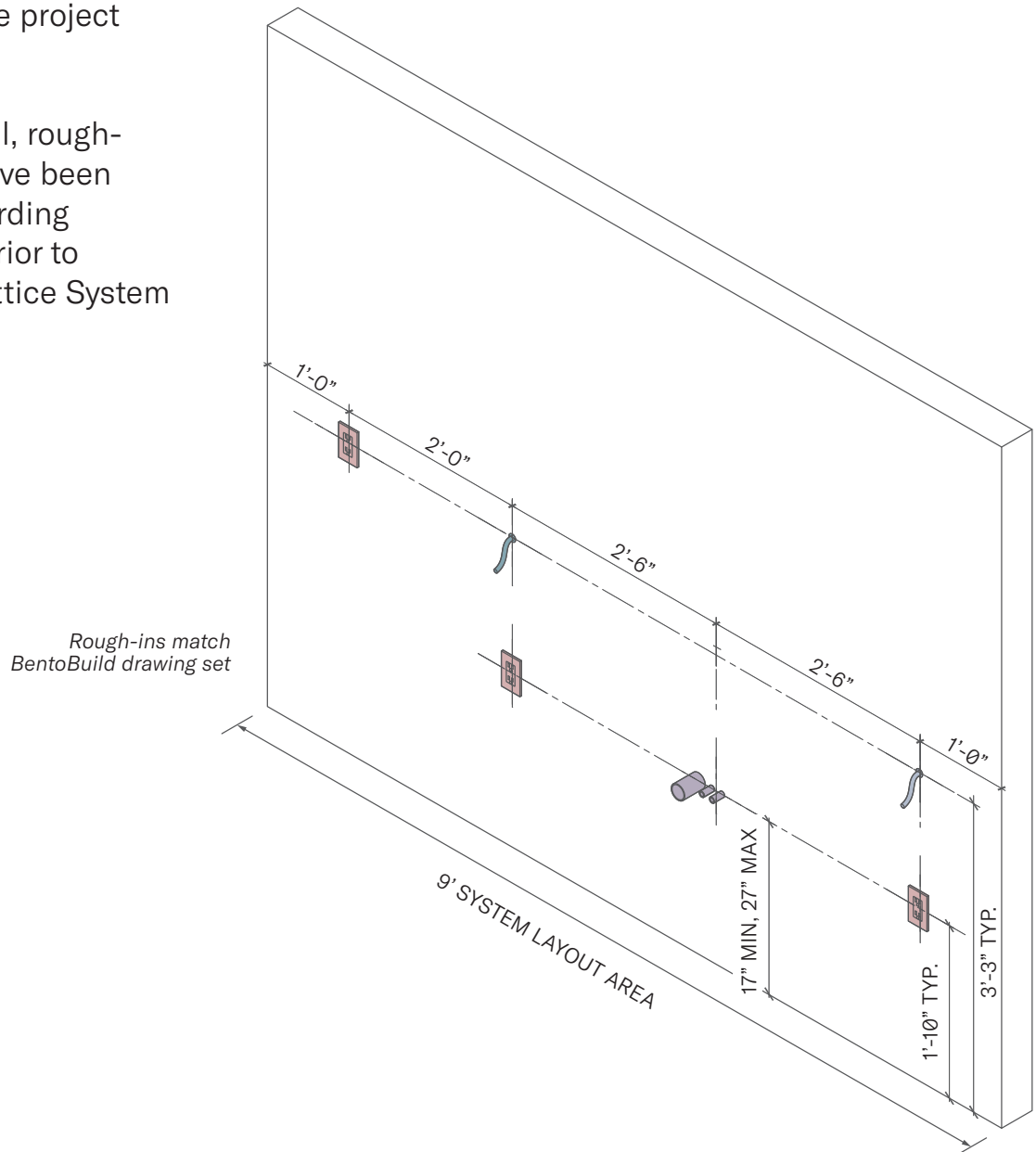

4 BENTOBUILD INSTALLATION

4.1 Lattice system installation

After electrical and plumbing rough-ins are complete, the Lattice System can be installed. This page is a brief overview of the Lattice System installation. For detailed instructions refer to BentoBuild Lattice Assembly Guide.

2 ½" clearance from finished face of wall to back of cabinet

Each BentoBuild Lattice System should be installed with at least ½" space on either side to make sure there is enough room to fit the system.

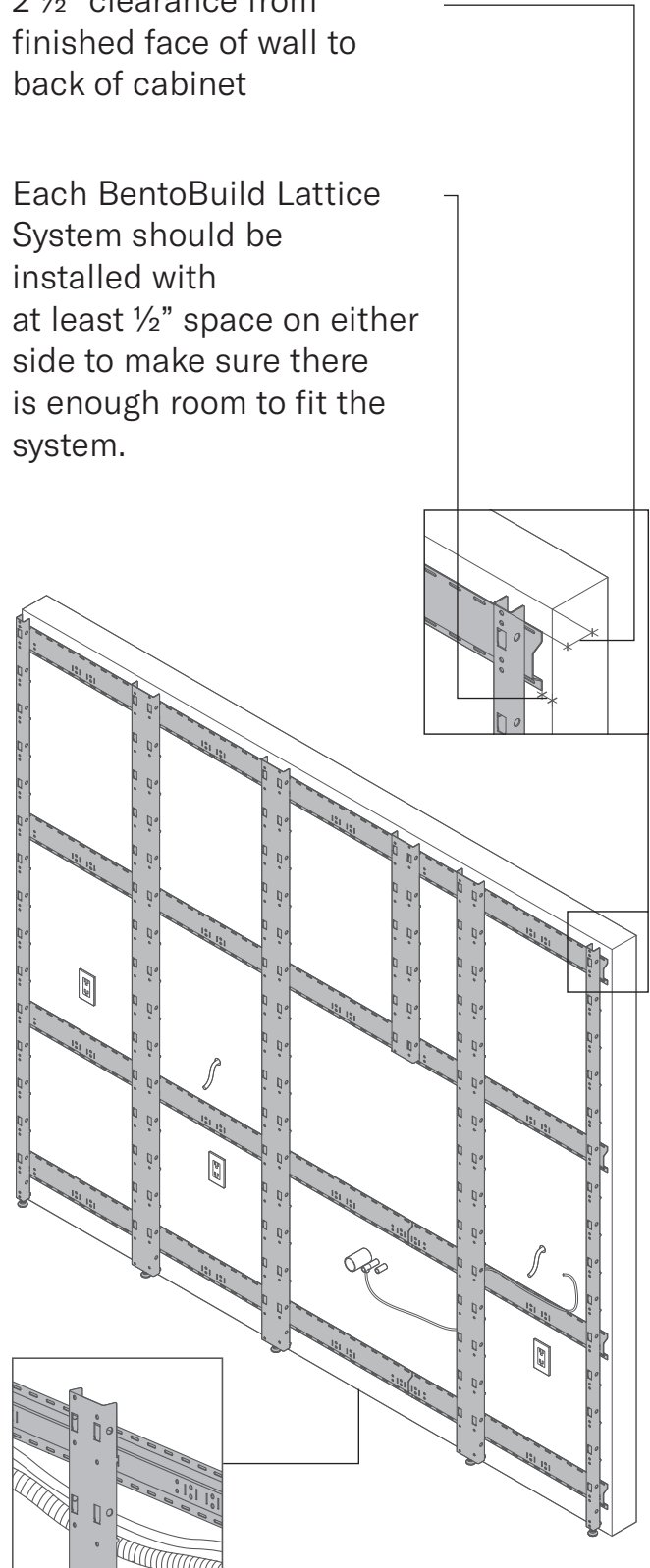

The BentoBuild Lattice System includes space for electrical and plumbing cables

4.2 Series 001 module installation

After the Lattice System installation is completed, modules will be installed from bottom to top, starting with base cabinets at bottom followed by countertop and backsplash above, followed by upper cabinets and panels on top.

Upon installation, electrical whips will be pulled through backsplash, and modules will be ready for final hookup.

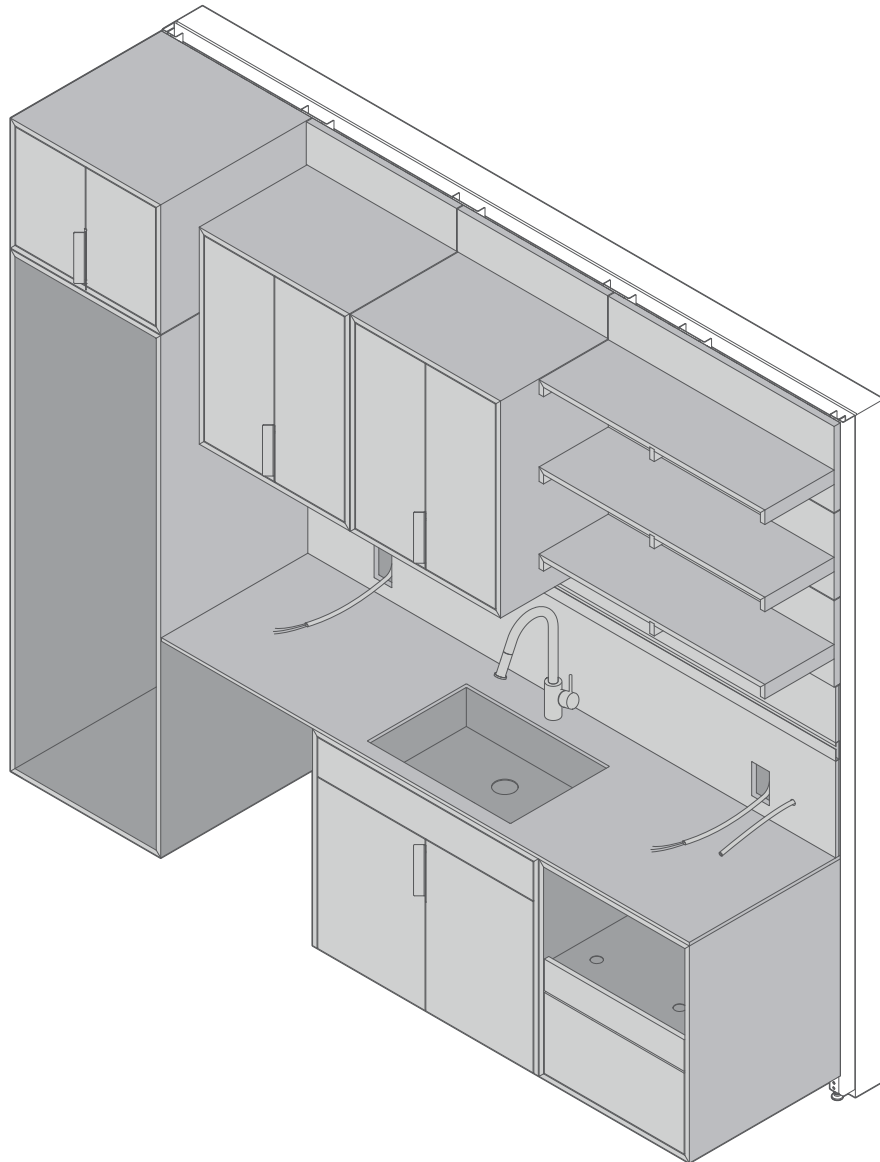

5 FINAL HOOKUP

5.1 Plumbing



Note: Plumber is responsible for connecting water to relevant appliances and faucets.

Rough-in

Waste line should follow local building code and be centered under the sink cabinet at the location shown on supplied BentoBuild drawing set.

Hot and cold water supply should follow local building code and be centered under the sink cabinet at the location shown on the supplied BentoBuild drawing set.

Countertop water supply

If water supply in backsplash module is necessary, follow these hook-up instructions.

We recommend using ¼" diameter Crosslinked High Density Polyethylene (PEX). This flexible tubing can be inserted through the 7/8" diameter hole in the Corian panel and run vertically in the space created by the Lattice System. The tubing can run horizontally in the 4" space under the cabinet and enter the sink cabinet through the open back. The tubing options on the next page are also acceptable. Tubing will be pulled through the backsplash and connected to a vacuum breaker as illustrated on page 21.

DIVISION OF RESPONSIBILITIES



Note: Refer to "Recommended vacuum breaker assembly" diagram on page 21 for installation details.

Provided by BentoBuild	1/2" Corian backsplash panel
	18 mm (3/4") baltic birch plywood panel

Provided by contractor	Watts series LFN388 hot or cold water anti-siphon vacuum breaker
	3/8" NPT male to 1/4" compression fitting
	T&S brass 002535-25 3/8" NPT close nipple
	.25 O.D. PEX flexible tubing, refer to page 22 for options
	T&S brass BL-4250-07 lab flanged elbow

**RECOMMENDED VACUUM
BREAKER ASSEMBLY**

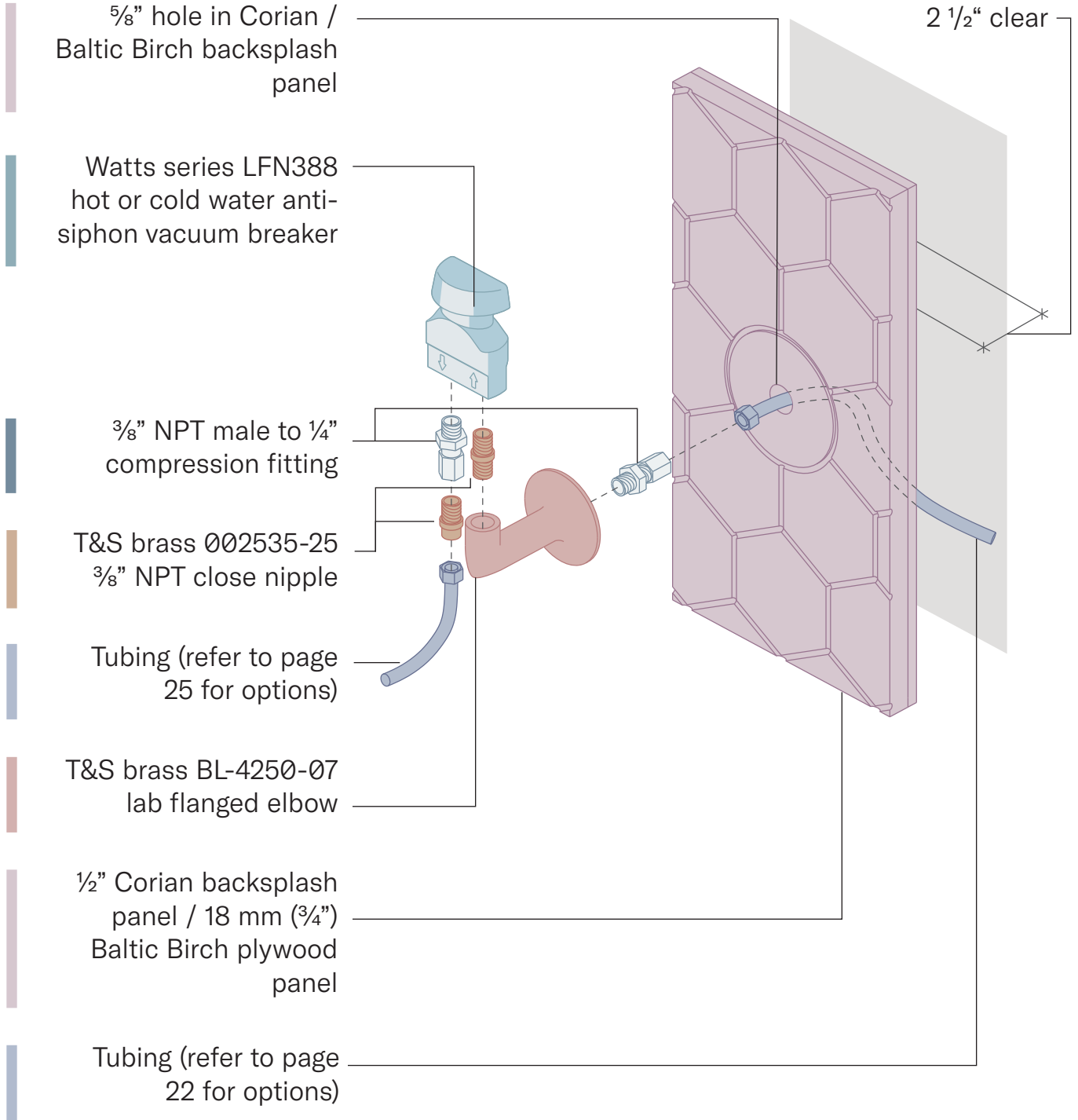

Additional options

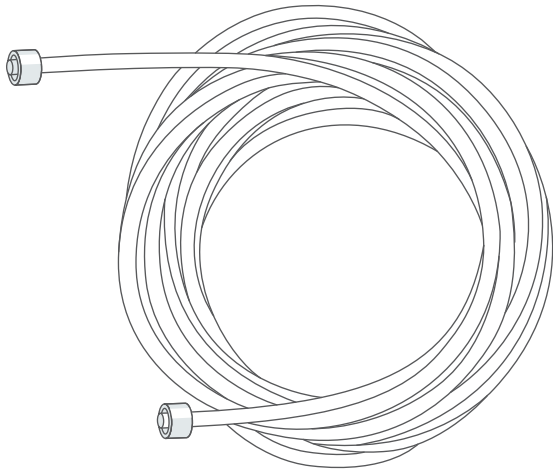

1/4" O.D. Pex
flexible tubing.

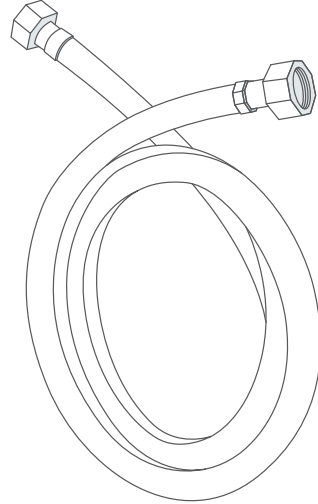

Braided stainless steel
with 3/8" connector.

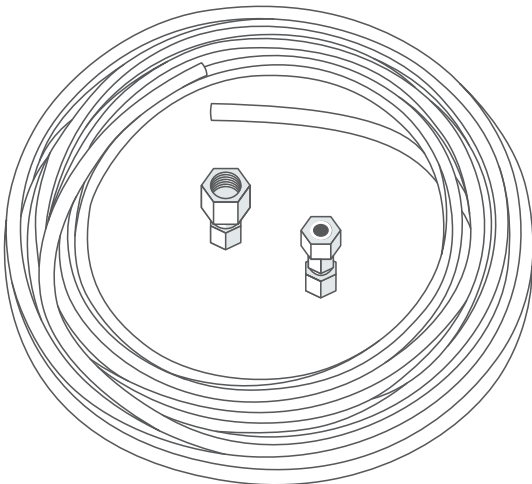

1/4" copper
flexible tubing.

5.2 Electrical



Note: Electrician is responsible for hard-wiring relevant appliances and installing outlets in backsplash.

If your design includes electrical outlets as part of the cabinetry, power will come from the wall behind the Lattice System. For under-cabinet appliances such as dishwashers and microwaves, use a single-gang receptacle.

The electrical outlets in the backsplash should be GFCI outlets in a metal gem box (or “old work” box) mounted directly to the front of the plywood backer from the front of the backsplash via plaster ears on the box. The electrical power for the backsplash will need to be left as a hanging BX whip prior to install to be pulled through the backsplash by a BentoBuild technician during installation.

DIVISION OF RESPONSIBILITIES

Provided by BentoBuild	1/2” Corian backsplash panel
	18 mm (3/4”) Baltic Birch plywood panel

Provided by contractor	Screwless snap-on face plate
	Single gang outlet*
	Single gang electrical switch box**
	AC armored electrical cable (BX cable) left hanging at wall, and pulled through backsplash

* 110V GFCI, typical 220V, where marked on drawings.

** No larger than 2” width x 3” height x 2.5” depth, with “plaster ears” for old work applications (flanges at top and bottom).

GFCI OUTLETS IN WALL PANELS + BACKSPASHES

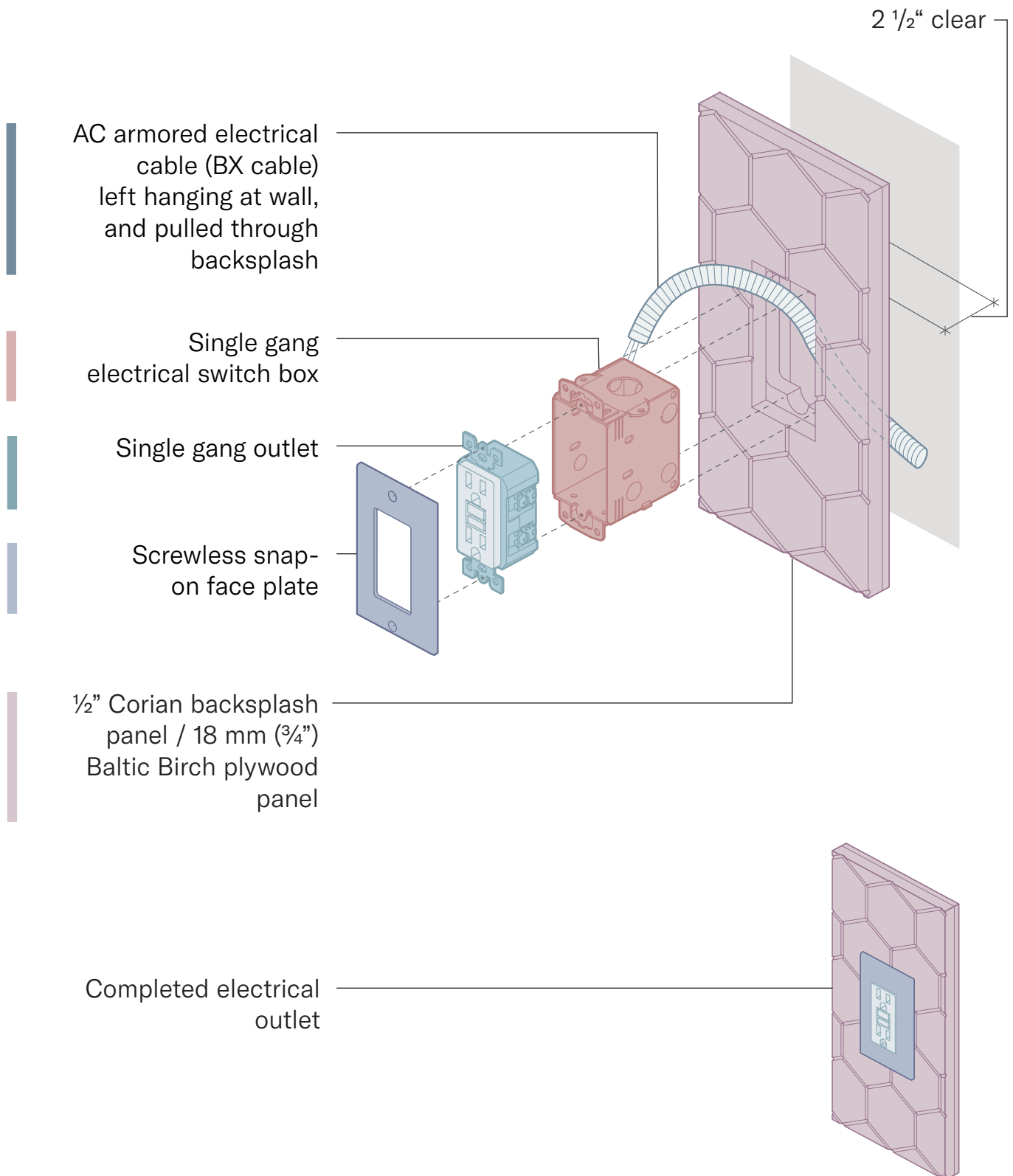

5.3 Appliances

BentoBuild modules are designed to fit only the following appliances:

Appliance	Model	Amp. Load	Connection Type
Bosch oven	SKU-HBE5451UC	30 amps	Hard-wired
Bosch cooktop	SKU-NEM5466UC	20 amps	Hard-wired
Bosch 36" wide refrigerator	B20CS30SNS	15 amps	3 prong plug
Bosch 24" wide refrigerator	B09IB81NSP	10 amps	3 prong plug
Bosch dishwasher	SGE53X55UC	12 amps	Plug or hard-wired
Whirlpool microwave	WMC30516HB	15 amps	3 prong-plug



Bosch oven

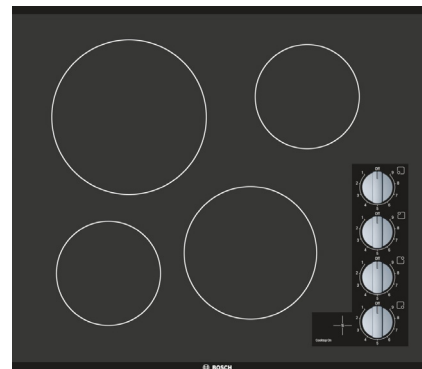

Bosch cooktop



Bosch 36" wide refrigerator



Bosch 24" wide refrigerator



Bosch dishwasher



Whirlpool microwave

Note: These appliances may be provided during install.
Images courtesy of Bosch and Whirlpool.

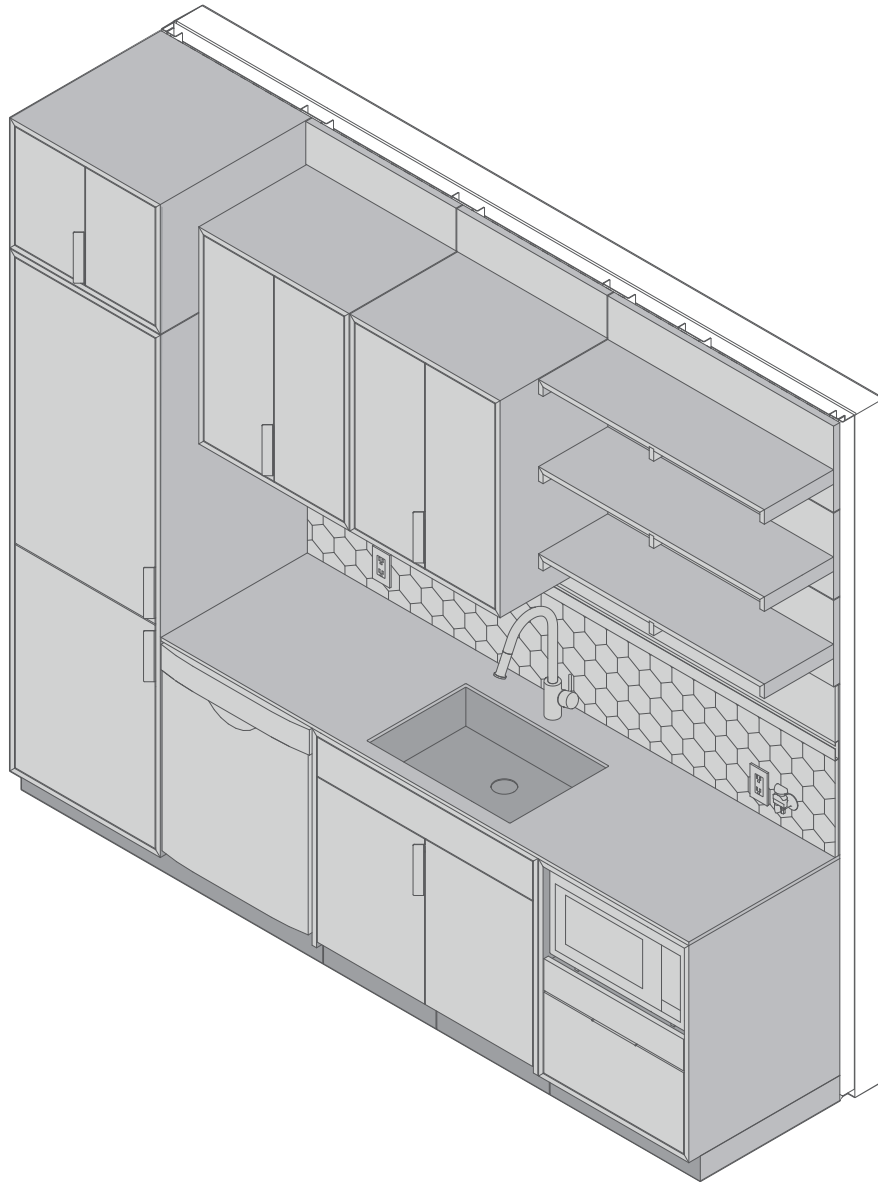

Further reading

For more information on the BentoBuild Lattice System please refer to the Lattice System Installation Guide and Series 001 Installation Guide.



BentoBuild
254 36th Street Floor 6, Suite C663
Brooklyn, NY 11232

o +1 718.260.8200
BentoBuild.com